

## TIRE GEOMETRIES

	Rim Width mm	Overall Diameter mm	Knob Shoulder Width mm	Max Casing Width mm	Radius at Knob Shoulder Width mm
<b>Endomorph</b>	100.0	736.0	92.0	106.0	340.0
	82.0	736.0	90.0	99.0	345.0
	65.0	736.0	88.0	91.0	349.0
<b>Larry</b>	100.0	745.0	99.0	111.0	347.0
	82.0	745.0	97.0	103.0	347.0
	65.0	745.0	94.0	96.0	344.0
<b>Black Floyd</b>	100.0	735.5	98.5	111.0	340.5
	82.0	735.5	95.5	102.0	340.0
	65.0	735.5	93.0	96.0	338.0
<b>Nate</b>	100.0	745.0	106.0	112.0	344.0
	82.0	745.0	104.0	104.0	342.0
	65.0	745.0	101.0	98.0	340.0
<b>Big Fat Larry</b>	100.0	756.5	111.0	118.0	348.0
	82.0	756.5	108.0	110.0	346.0
	65.0	756.5	105.0	104.0	343.0
<b>Bud</b>	100.0	775.5	123.5	125.0	353.5
	82.0	775.5	118.0	117.0	350.0
	65.0	775.5	117.5	111.0	347.0
<b>Lou</b>	100.0	778.0	122.0	124.0	354.0
	82.0	778.0	120.0	117.0	351.0
	65.0	778.0	118.0	113.0	349.0
<b>Knard 4.8</b>	100.0	771.5	126.5	126.0	346.0
	82.0	771.5	122.5	120.0	343.0
	65.0	771.5	118.5	113.0	341.0
<b>Knard 3.8</b>	100.0	742.0	107.0	112.0	343.0
	82.0	742.0	103.0	103.0	341.0
	65.0	742.0	101.0	98.0	339.0
<b>Knard 29+</b>	50.0	775.0	79.0	77.5	362.0
<b>Knard 26+</b>	65.0	714.5	81.0	83.5	335.0
	50.0	714.5	79.0	79.0	333.0
<b>Knard 700c</b>	24.0	717.0	40.0	42.0	347.5
<b>Knard 650b</b>	24.0	677.0	40.0	42.0	328.0
<b>Dirt Wizard 26 x 2.75"</b>	50.0	700.0	70.5	69.0	333.0
<b>Dirt Wizard 29 x 3.0"</b>	50.0	761.0	75.0	71.0	364.0
<b>Dirt Wizard 27.5 x 3.0"</b>	50.0	725.0	76.5	71.5	345.0
	35.0	725.0	74.5	66.5	342.0
<b>Extra Terrestrial 26 x 2.5</b>	50.0	693.0	67.5	70.0	327.0
	24.0	693.0	63.0	60.0	321.0
<b>Extra Terrestrial 29 x 2.5"</b>	50.0	758.0	68.5	71.0	359.0
	24.0	758.0	64.0	60.5	352.0

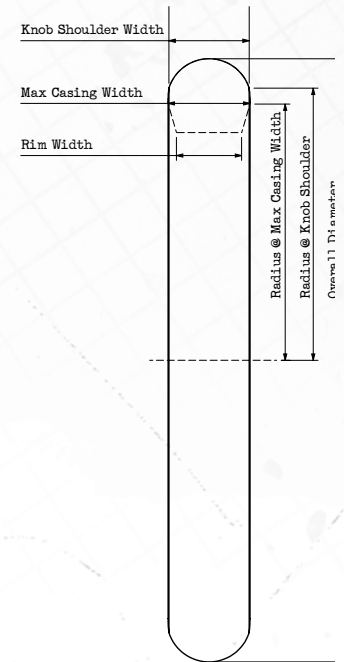

Note: 1.) Dimensions were all taken at the tire's max PSI  
 2.) There is variability in all the posted geometries/dimensions; depending on rim/psi use

**Surly**  
 6400 West 105th Street  
 Bloomington, MN 55438  
**The Watts Line:** 877.743.3191  
**The Email:** derby@surlybikes.com  
**The Web Address:** www.surlybikes.com