



Singleator Instructions

Hi there. Thanks for spending your hard-earned cash on this Surly product. Surly stuff is designed to be useful and durable. We're confident it will serve you well for years to come.

Installing horizontal dropouts on your frame can be difficult and expensive, particularly if your steel is of the aluminum variety. The Singleator mounts to your derailleur hanger and provides a simple, effective, and adjustable means of tensioning the excess chain slack found in vertical dropout single-speed drivetrains. We've made some improvements over the last version. The main body is now forged versus CNC-machined. And we've replaced the chain guide loop with circular chain guide plates, so the new Singleator is compatible with 3/32" and 1/8" chains.

⚠WARNING: Cycling can be dangerous. Bicycle products should be installed and serviced by a professional mechanic. Never modify your bicycle or accessories. Read and follow all product instructions and warnings including information on the manufacturer's website. Inspect your bicycle before every ride. Always wear a helmet.

For additional safety information about all Surly products visit: surlybikes.com/safety

⚠WARNING: This product was not designed for any purpose other than for use on a bicycle with one chainring, one freewheeling rear cog, one chain, and one rear derailleur hanger. This product is not for use with a coaster brake or fixed gear. Don't do it.

⚠WARNING: Don't attempt to install this product unless you completely understand the instructions, have the proper tools, and possess the skills required. This installation is best left to an experienced, professional bicycle mechanic.

Tools Required

- 18mm cone wrench (You'll want this or a Surly Singleator wrench on your person or in your bike's tool kit when you ride anyways)
- 4, 5mm Allen wrenches
- Small flat bladed screwdriver
- Torque wrench that measures in Nm

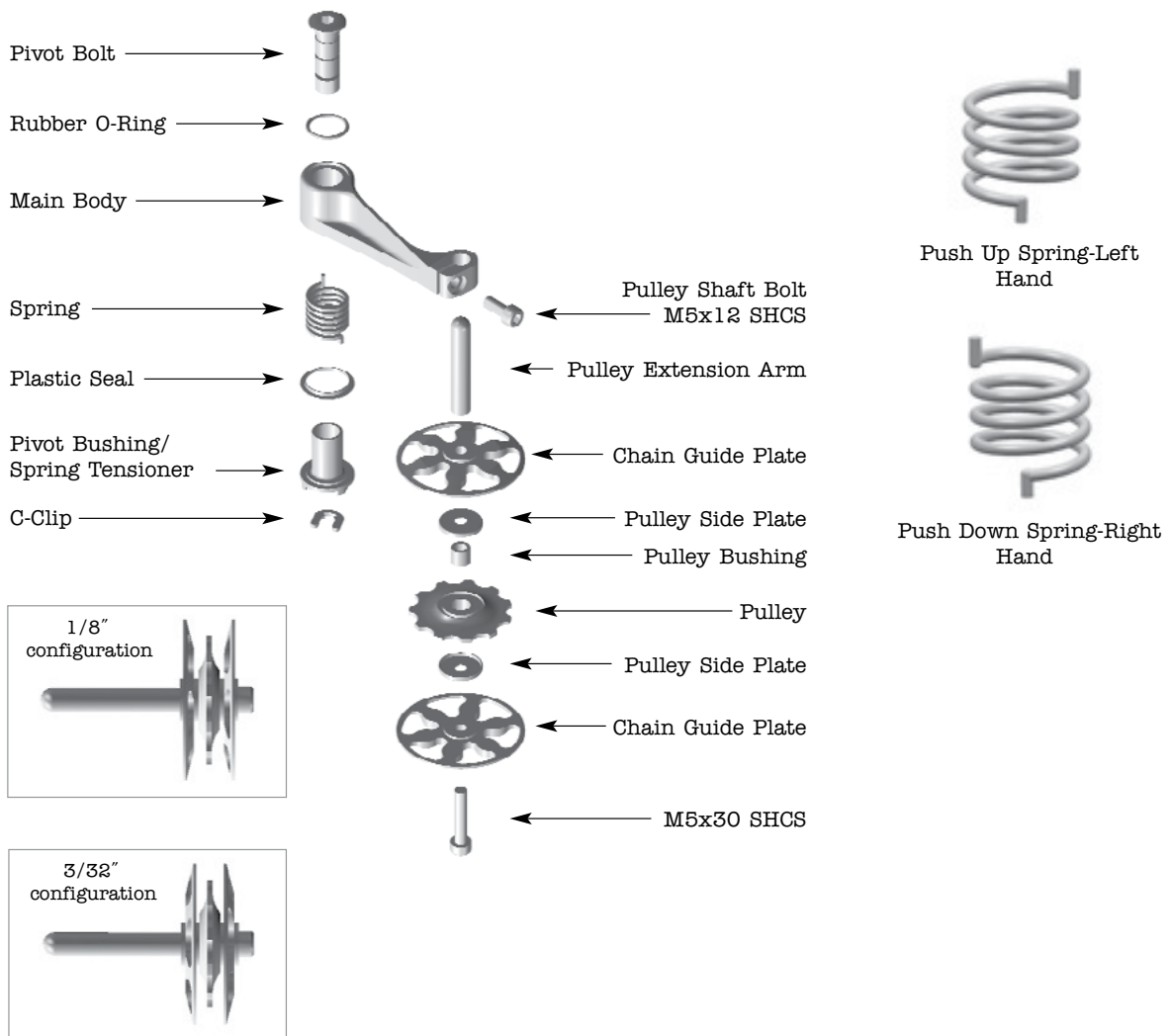

Instructions:

1. Remove all the gear-shifting-related crap: shifters, derailleurs, multiple chainrings, cogs.
2. Choose the desired front chainring and rear cog combination, and install these parts. Cogs larger than 24t pose a problem, so keep them smaller than that. For best results, we recommend using our non-ramped stainless steel singlespeed chainrings and steel cogs.
3. Size the chain, and install it. The chain should be as short as possible without binding.
4. Reposition the chainring and cog, as necessary, to ensure a nice, straight chainline. A good chainline is the key to an efficient, quiet, and longlasting drivetrain.
5. Are you using a 3/32" chain? If so, proceed to the next step. If you are using a 1/8" chain, you must turn both chain guide plates 180 degrees, so the beveled edges are facing the pulley. See the diagrams on the front of this page.
6. Thread the Singleator assembly onto your derailleur hanger, but don't cinch the pivot bolt down yet.
7. Align the Singleator pulley under the chain and tighten the pulley shaft bolt. Perfect alignment will be important later, but for now, just get it close.
8. Now, it gets tough. You have the choice of having the Singleator run under the chain and PUSH UP (Figure 2) on the chain, or having the Singleator run on top of the chain and PUSH DOWN (Figure 1). Depending on the configuration of your frame, what gear you are running, and how much chain slack there is, you may be forced into one position or the other. The Singleator is shipped with the PUSH DOWN spring installed, because this configuration accommodates most drivetrains. If you have a choice, PUSHING UP will give you more chain wrap, and PUSHING UP will lessen the chances of your chain skipping over the teeth of your cog. However, if you want to PUSH UP, you must change the spring.
9. Changing the spring. See the diagram on the front of this page for the assembly sequence. Pull the Singleator off the bike. Use a small, flat-bladed screwdriver to pry off the C-clip (Figure 3). Removal of the pivot bushing and plastic seal will give you access to the spring. Swap springs, and reassemble your Singleator. Make sure the spring tabs are fully seated in their anchoring holes, and that everything is well greased.
10. Thread the Singleator back onto the bike, but don't cinch the pivot bolt tight yet. Position the pulley under or over the chain, per your spring decision. Perfectly align the pulley under/over the chain.
11. Tension the Singleator spring by slipping an 18mm cone wrench onto the wrench flats of the pivot bushing and tension as follows: PUSHING DOWN spring, turn CLOCKWISE (Figure 4). PUSHING UP spring, turn COUNTERCLOCKWISE (Figure 5).
12. Once you have adequate tension, fully tighten the pivot bolt to 9 Nm.
13. Spin the drivetrain, and make sure everything is properly aligned. Your drivetrain should be straight, quiet, lubricated, and not rubbing. Bounce the bike around, and make sure you have enough tension on the Singleator. Increase/decrease tension and align as necessary.



Figure 1



Figure 2

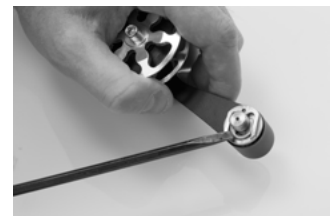

Figure 3



Figure 4



Figure 5

Ongoing Maintenance

Always check your Singleator for damage, problems, and proper adjustment before each ride. A little lube on the pivots and the pulley wheel goes a long way too.

Limited Warranty

This Surly product is warranted against defects in materials and workmanship for one year from the date of retail purchase of the product, subject to the limitations detailed below. Save your dated receipt for proof of purchase.

This warranty does NOT cover the following:

- Damage due to improper assembly or follow-up maintenance or lack of skill, competence or experience of the user or assembler
- Products that have been modified, neglected, used in competition or for commercial purposes, misused or abused, involved in accidents or anything other than normal use
- Installation of components, parts or accessories not originally intended for or compatible with bicycle as sold
- Damage or deterioration to the paint, surface finish, aesthetics or appearance of the product
- Normal wear and tear
- Labor required to remove and/or refit and re-adjust the product within the bicycle assembly

This limited warranty is expressly limited to the repair or replacement of a defective product, at the option of Surly, and is the sole remedy of the warranty. This limited warranty applies only to the original purchaser of the Surly product and is not transferable. This warranty applies only to products purchased through an authorized dealer or distributor. In no event shall Surly be liable for any loss, inconvenience or damage, whether direct, incidental, consequential, or otherwise resulting from breach of any express or implied warranty or condition, of merchantability, fitness for a particular purpose, or otherwise with respect to our products except as set forth herein.

This limited warranty gives the consumer specific legal rights, and those rights and other rights may vary from place to place. This limited warranty does not affect your statutory rights.

TO THE EXTENT NOT PROHIBITED BY LAW, THESE WARRANTIES ARE EXCLUSIVE AND THERE ARE NO OTHER EXPRESS OR IMPLIED WARRANTIES OR CONDITIONS INCLUDING WARRANTIES OR CONDITIONS OF MERCHANTABILITY AND FITNESS FOR A PARTICULAR PURPOSE.

OTHER PRODUCTS:

Give us a call for a free catalog or visit our website to check out all our stuff—you won't be disappointed.

Surly

6400 West 105th Street
Bloomington, MN 55438

The Watts Line: 877.743.3191

The Email: derby@surlybikes.com

The Web Address: www.surlybikes.com